

STOPCOCK

MS SERIES

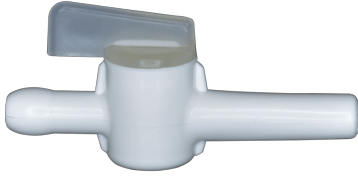

This is a miniature stopcock made of high-density polypropylene. The key turns easily so no lubricant is needed, eliminating blockage of the bores with grease. This is not for pressurized lines.

2WS SERIES



This easily mountable 2-way Stopcock is constructed from high-quality polypropylene and polyethylene, ensuring durability and reliability. It is designed to operate efficiently within a temperature range of 41°F to 104°F, making it suitable for various applications. Additionally, this stopcock can withstand a max pressure of 14.5 psi, providing robust performance under demanding conditions. In conclusion, its user-friendly design allows for quick and secure mounting, making it an ideal choice for residential and commercial use.

HFSC SERIES STOPCOCKS



4-way Stopcock is available in Polycarbonate, Acetal, Polyethylene, HDPE, Acrylic and Silicone. These Stopcocks are chemically resistant and not made with DEHP. Connection options include male luer slip, male luer lock, male luer with spin lock, rotating male luer lock, female luer lock, and tubing ports. Psi is 50, higher pressures are available on request.

SKU	DESCRIPTION
HFSC-4-MSFF-PC	4-Way Stopcock Male Slip by FF Polycarbonate
HFSC-4-FFF-PC	4-Way Stopcock FFF Polycarbonate
HFSC-4-FFM-PC	4-Way Stopcock FFM Polycarbonate
HFSC-4-FMM-PC	4-Way Stopcock FMM Polycarbonate
HFSC-4-FMF-PC	4-Way Stopcock FMF Polycarbonate
HFSC-4-MFF-PC	4-Way Stopcock MFF Polycarbonate
HFSC-4-MFM-PC	4-Way Stopcock MFM Polycarbonate
HFSC-4-MMF-PC	4-Way Stopcock MMF Polycarbonate
HFSC-4-MMM-PC	4-Way Stopcock MMM Polycarbonate
HFSC-4-MSFF-PC	4-Way Stopcock Male Slip by FF Polycarbonate